

Black = Main Level
 Red = Upper Level

Scale: 12' ⇔ 1"

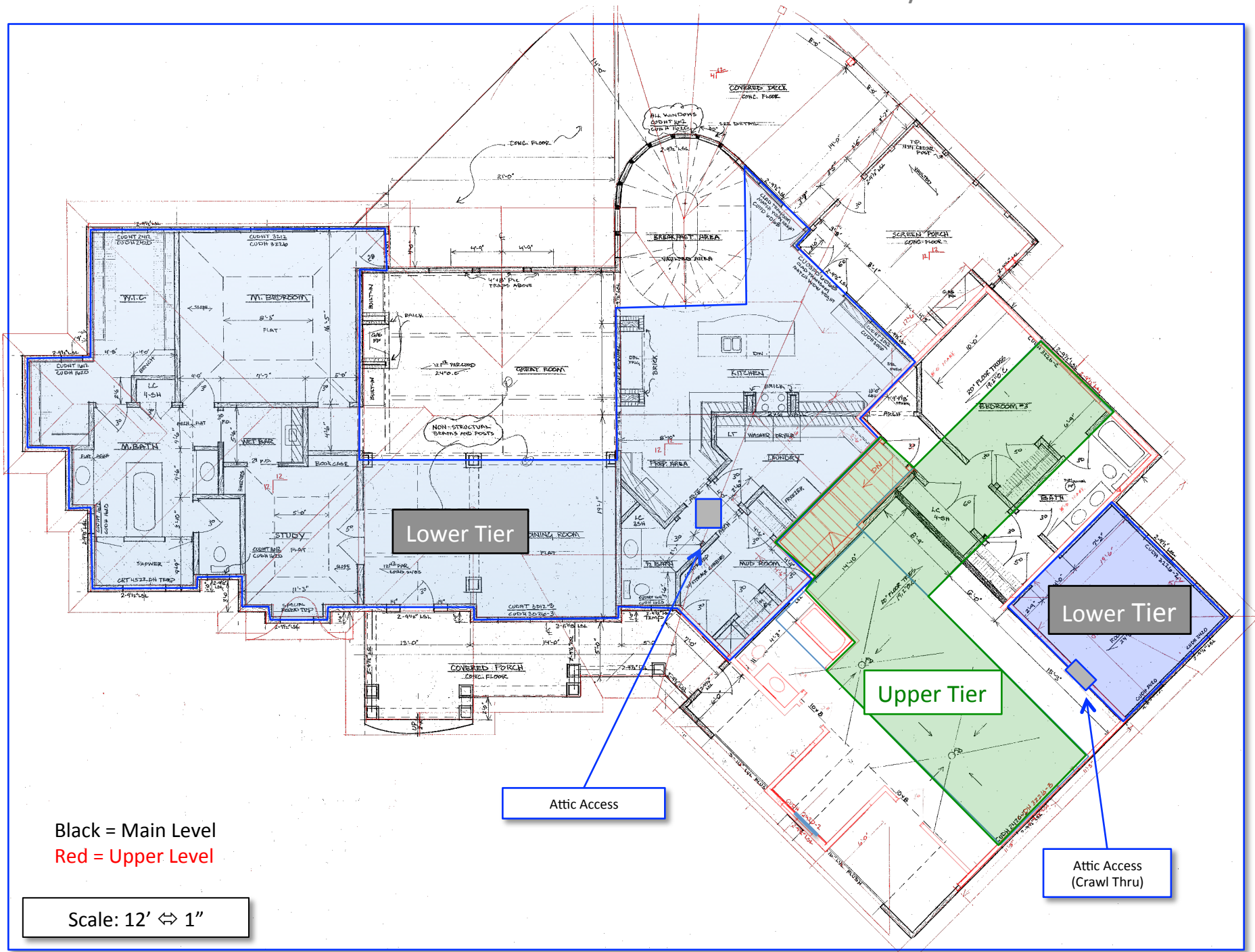

Lower Tier

Lower Tier

Upper Tier

Attic Access

Attic Access (Crawl Thru)

Black = Main Level
Red = Upper Level

Scale: 12' ⇔ 1"

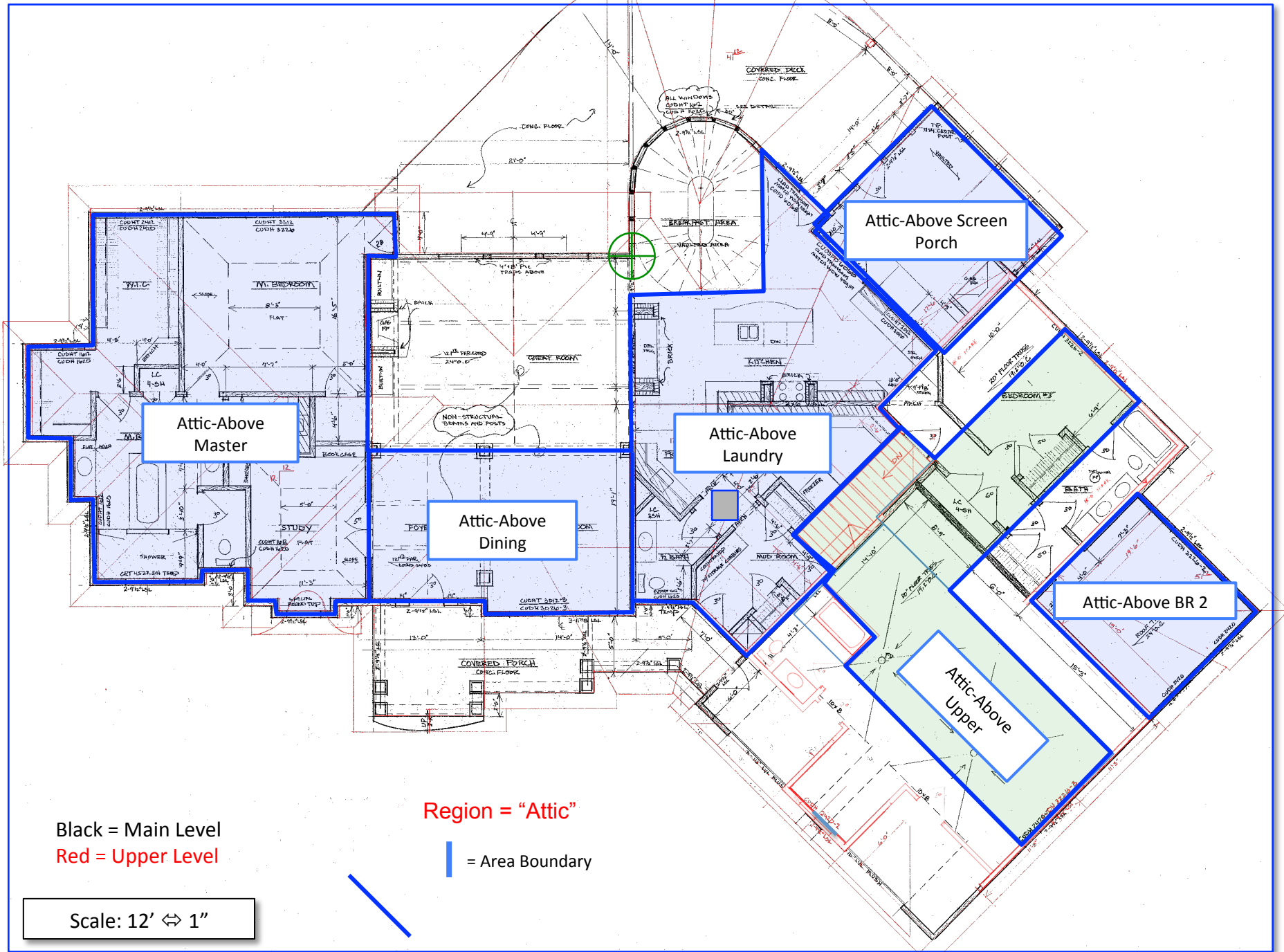

Black = Main Level
 Red = Upper Level

Region = "Attic"

— = Area Boundary

Scale: 12' ⇔ 1"

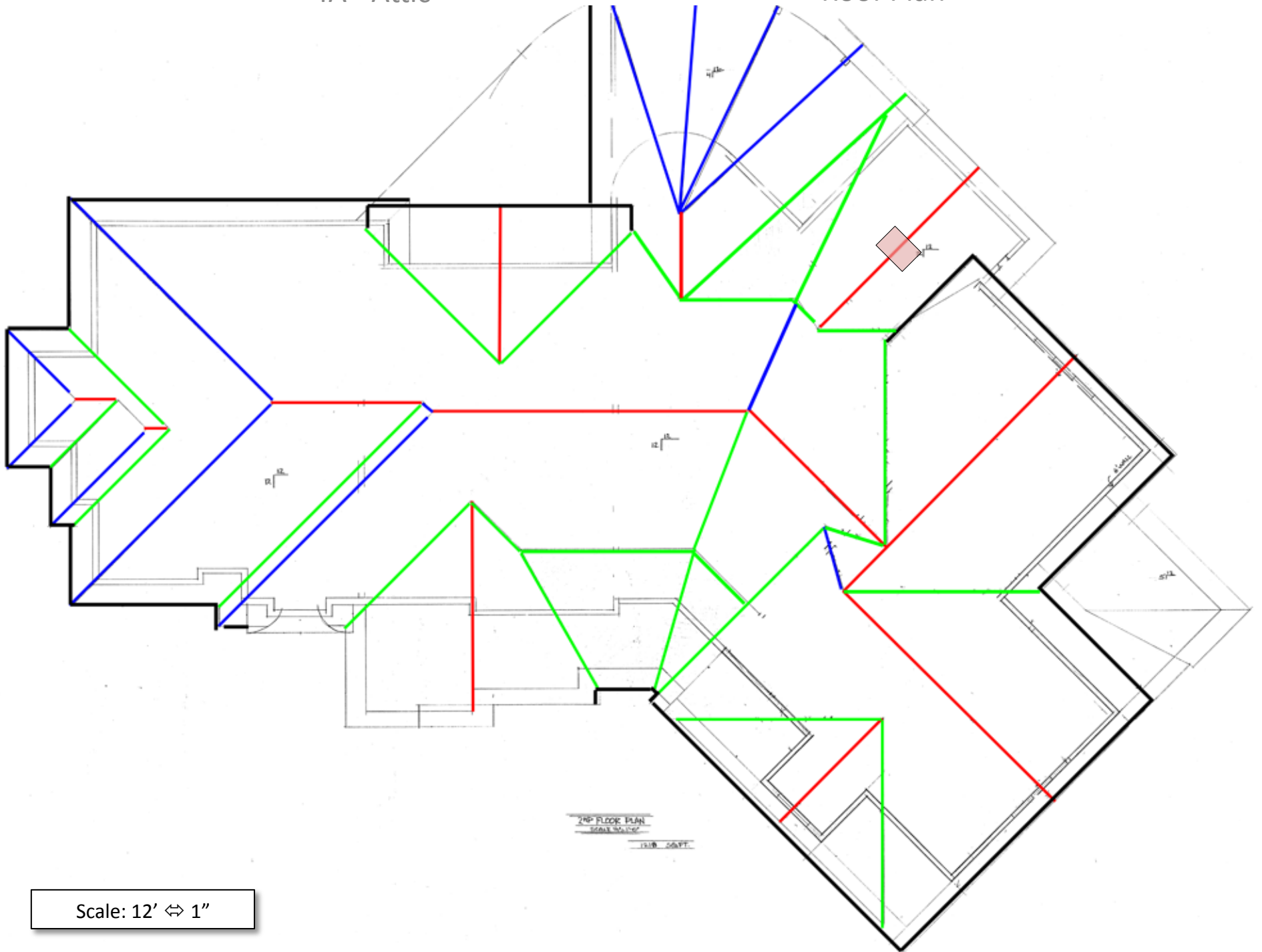

Scale: 12' ⇔ 1"

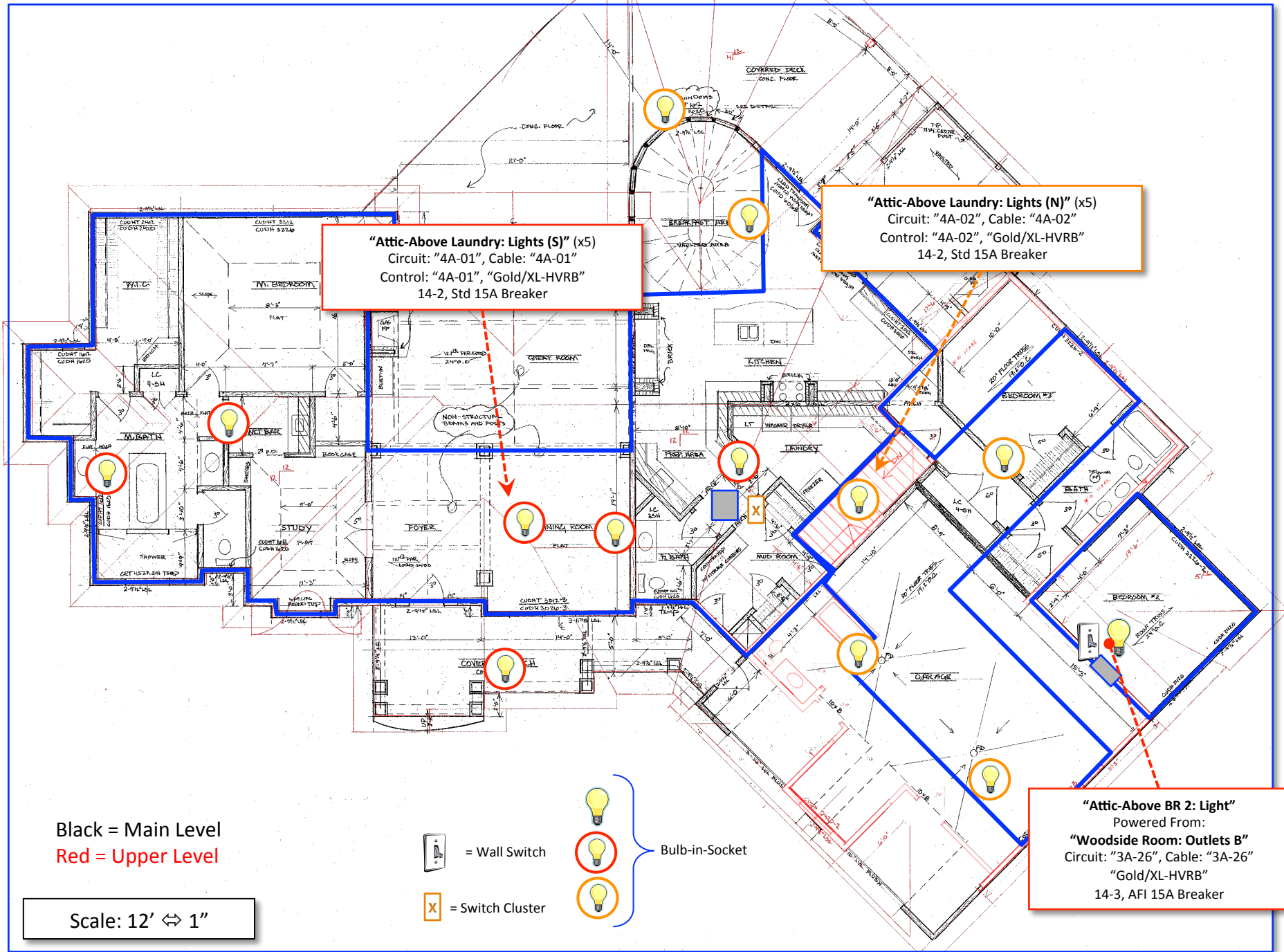

"Attic-Above Laundry: Lights (S)" (x5)
 Circuit: "4A-01", Cable: "4A-01"
 Control: "4A-01", "Gold/XL-HVRB"
 14-2, Std 15A Breaker

"Attic-Above Laundry: Lights (N)" (x5)
 Circuit: "4A-02", Cable: "4A-02"
 Control: "4A-02", "Gold/XL-HVRB"
 14-2, Std 15A Breaker



"Attic-Above BR 2: Light"
 Powered From:
"Woodside Room: Outlets B"
 Circuit: "3A-26", Cable: "3A-26"
 "Gold/XL-HVRB"
 14-3, AFI 15A Breaker

Black = Main Level
 Red = Upper Level

Scale: 12' ⇔ 1"

 = Wall Switch

 = Switch Cluster

   } Bulb-in-Socket

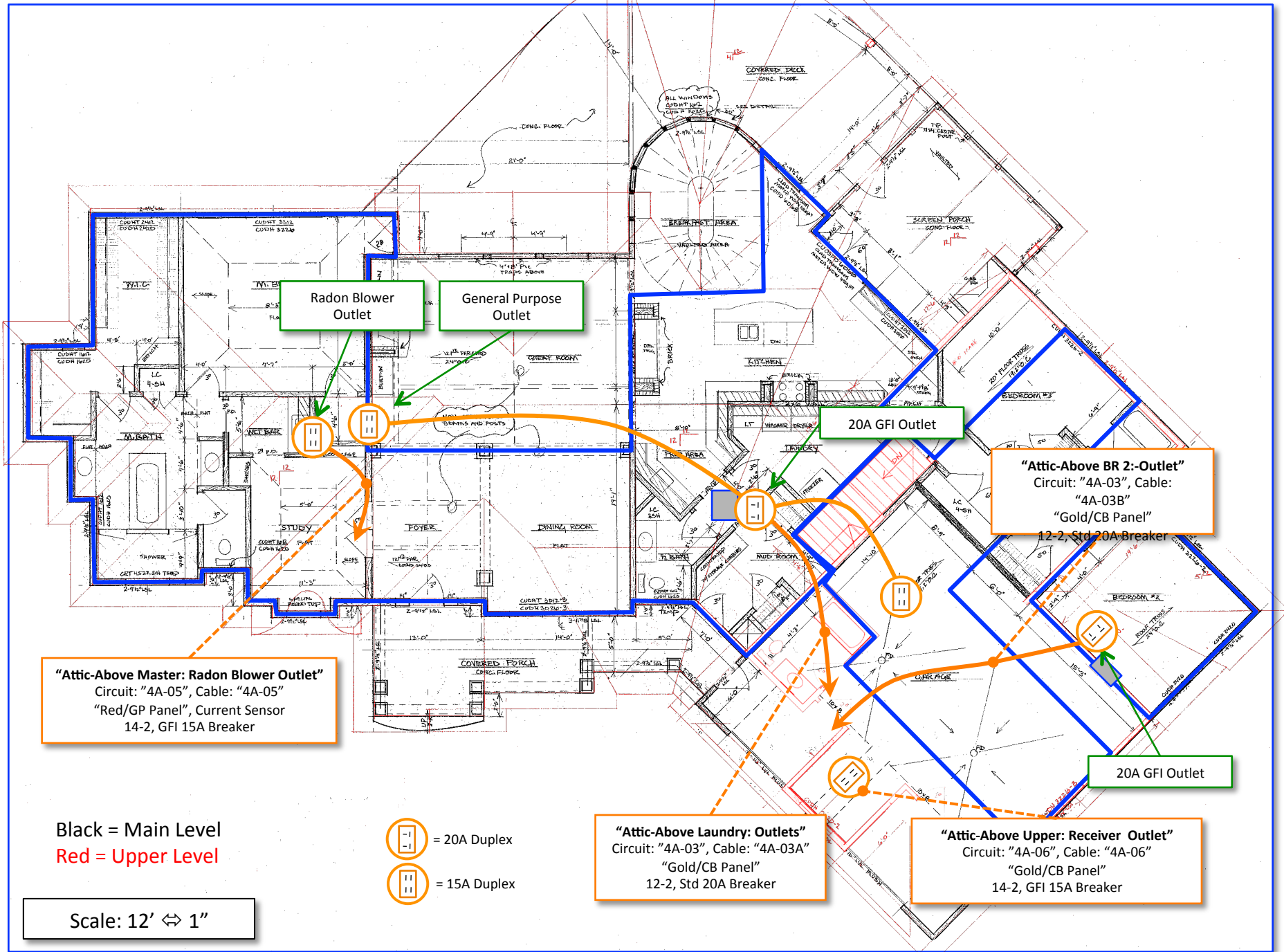

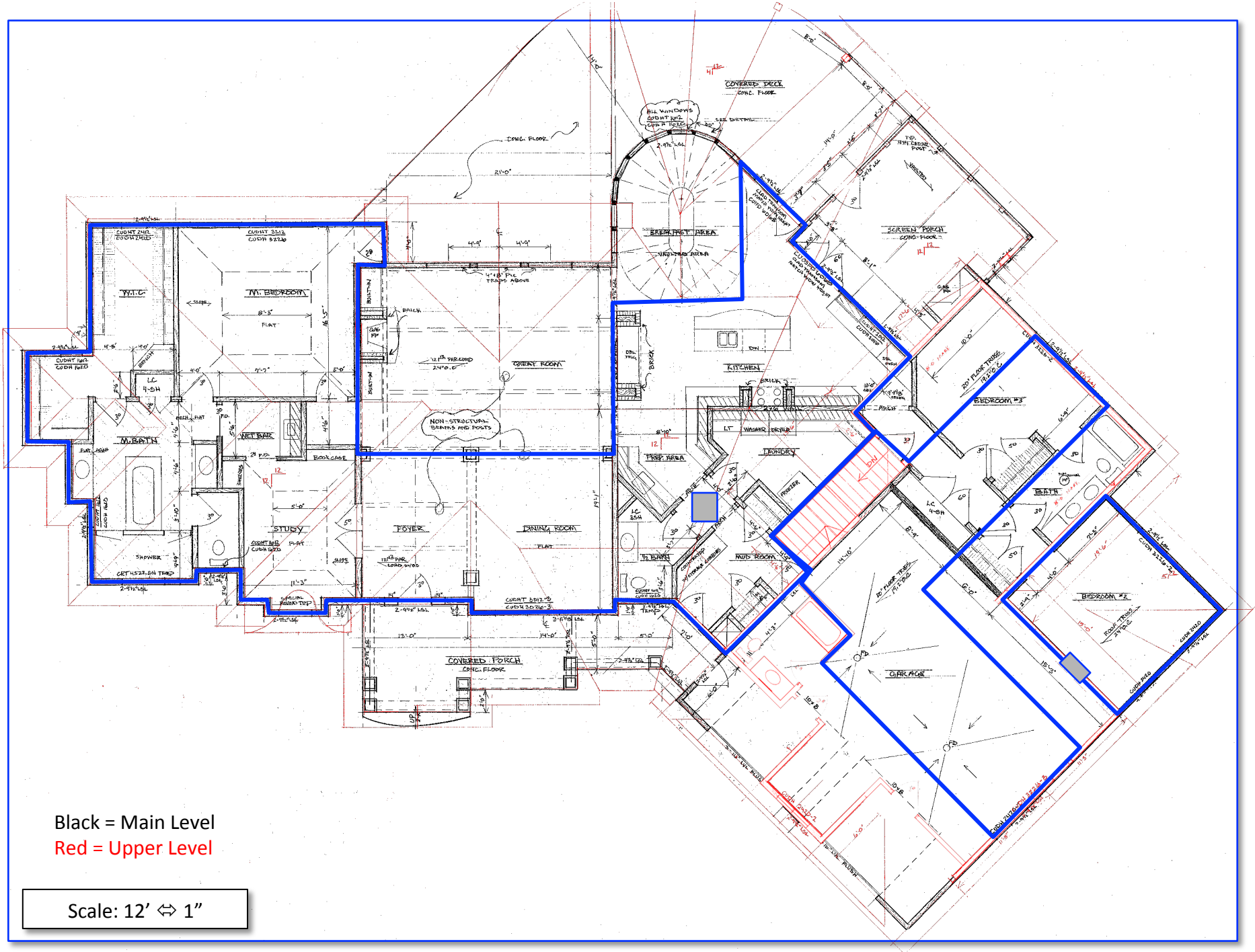

Black = Main Level
 Red = Upper Level

Scale: 12' ⇔ 1"

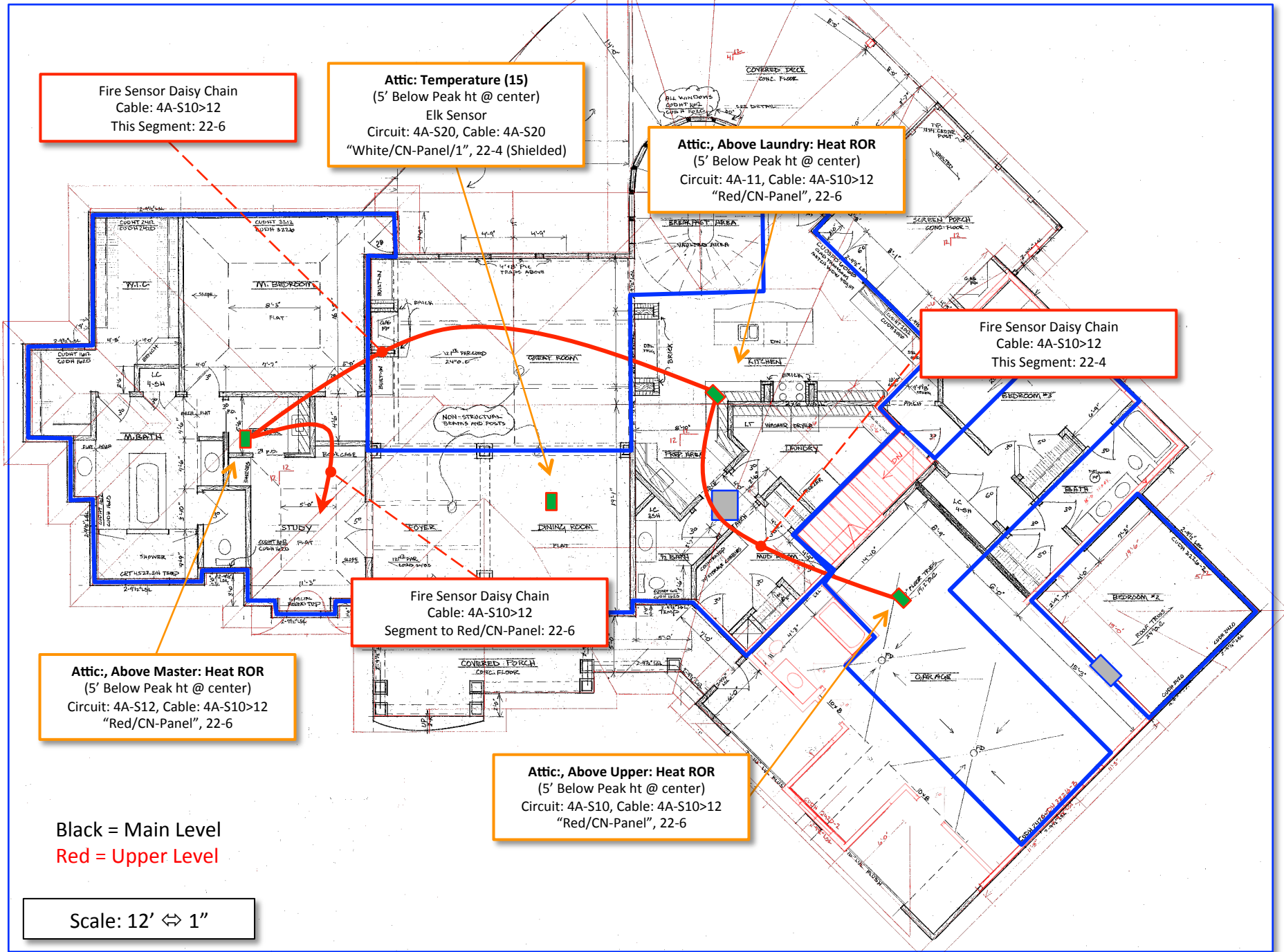

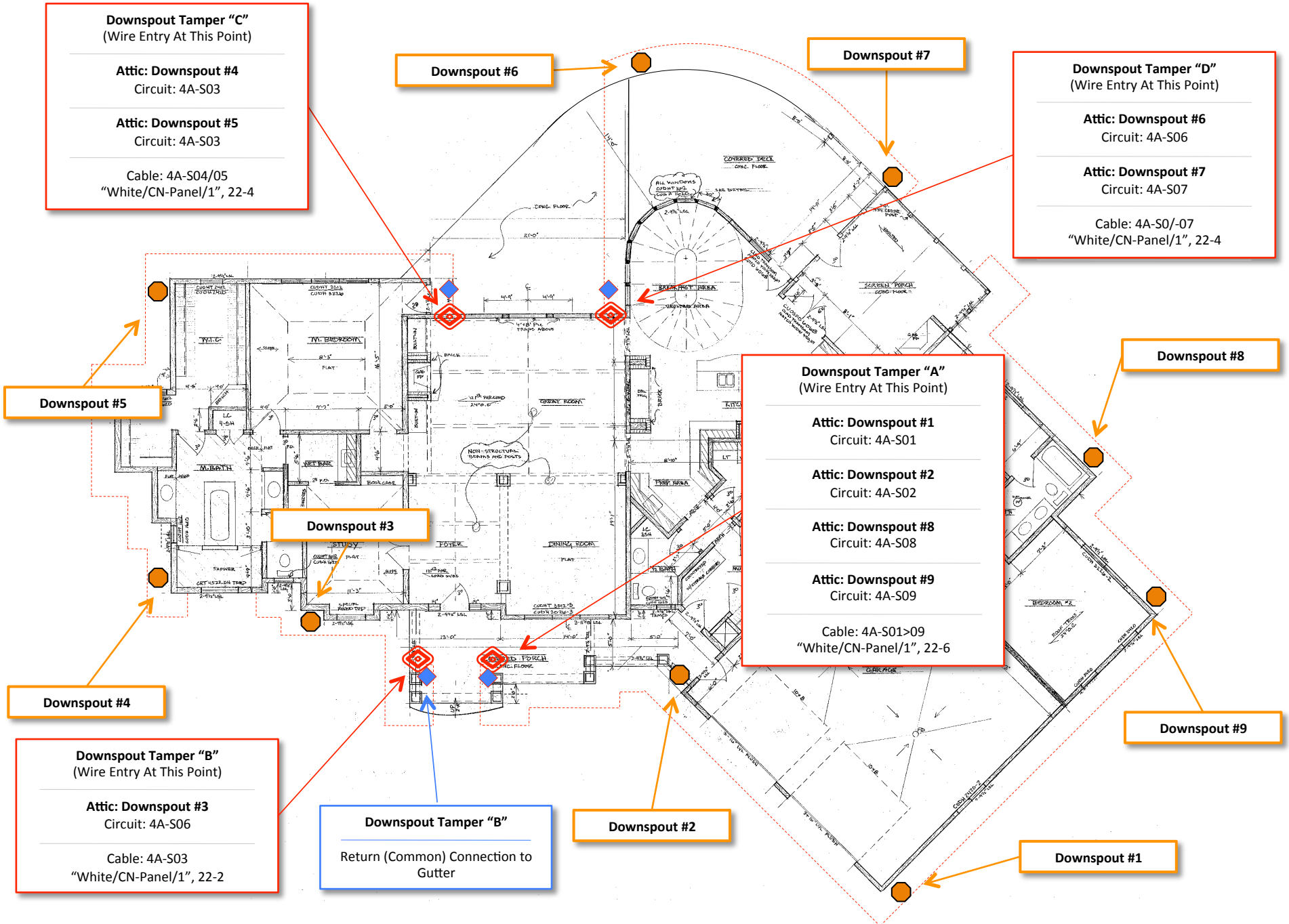

Scale: 14' ⇔ 1"

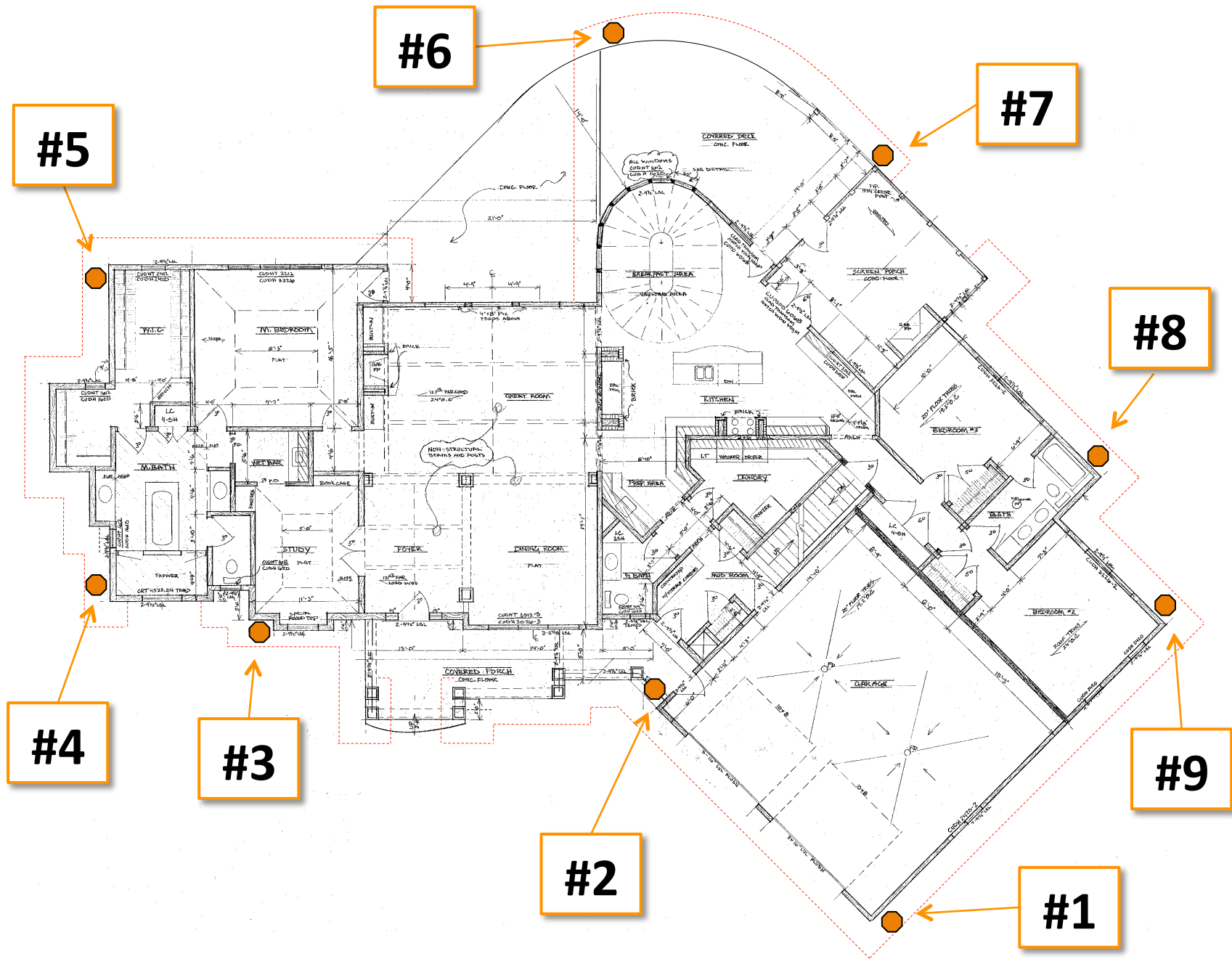

Attic: TV Antenna
 In Attic
 107 deg True Az
 In-Line Amp
 Circuit: 4A-R02, RG-6, (Quad Shield)
 "White/CN-Panel/3"

Attic: FM Antenna
 In Attic
 107 deg True Az
 No Amp
 Circuit: 4A-R01, RG-6 (Quad Shield)
 "White/CN-Panel/3"

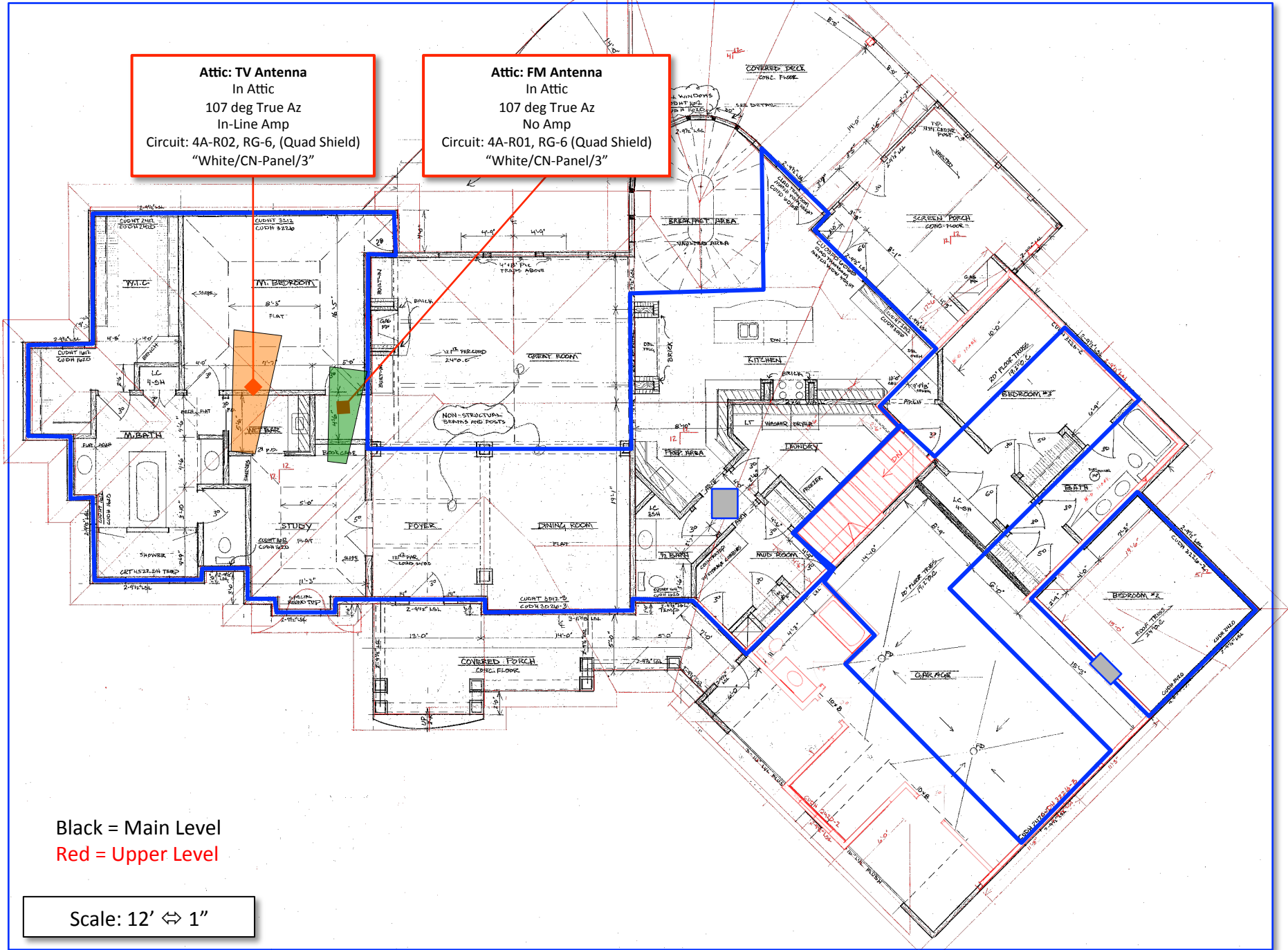

Black = Main Level
 Red = Upper Level

Scale: 12' ⇔ 1"

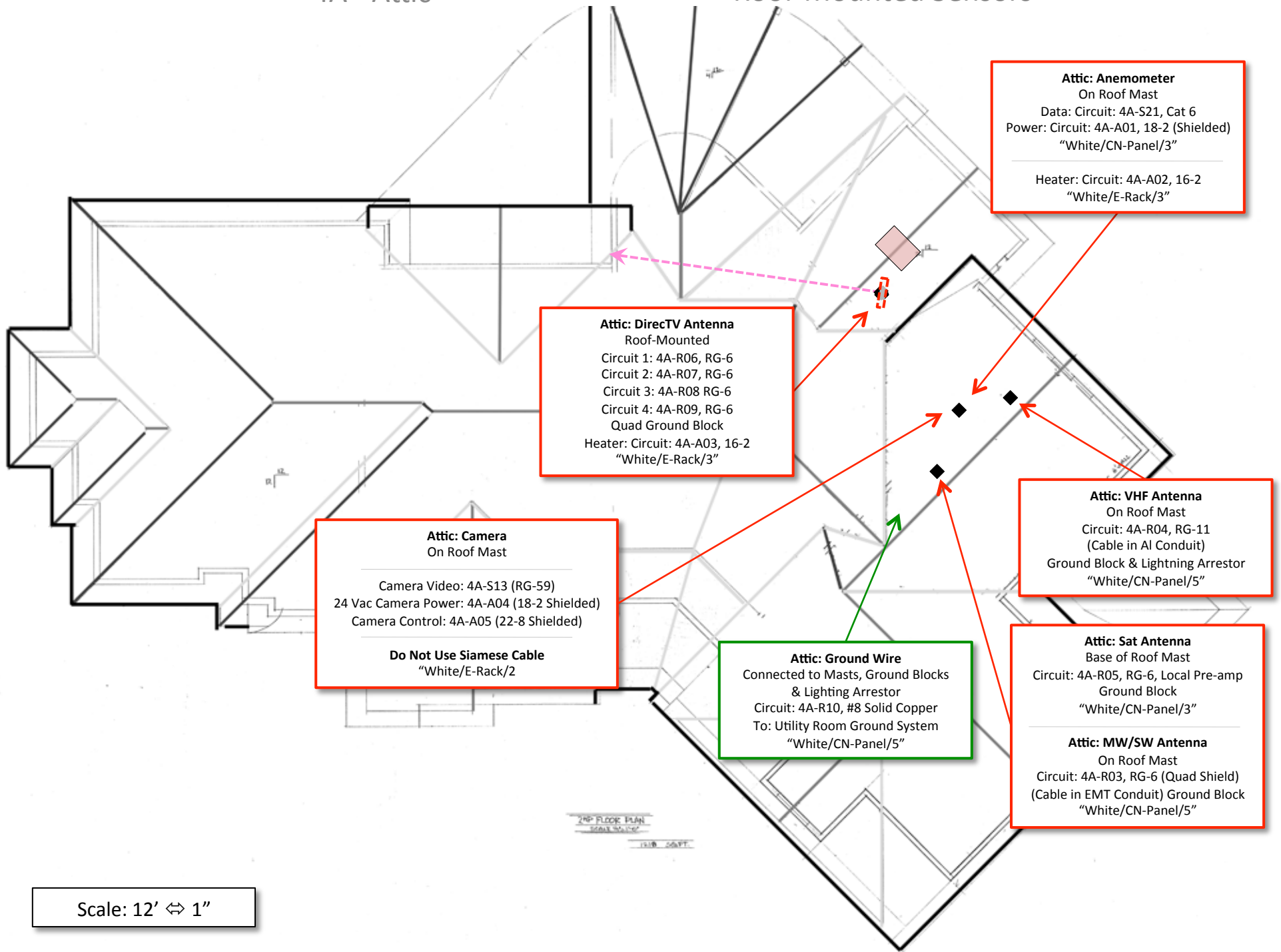

Attic: Anemometer
 On Roof Mast
 Data: Circuit: 4A-S21, Cat 6
 Power: Circuit: 4A-A01, 18-2 (Shielded)
 "White/CN-Panel/3"

Heater: Circuit: 4A-A02, 16-2
 "White/E-Rack/3"

Attic: DirecTV Antenna
 Roof-Mounted
 Circuit 1: 4A-R06, RG-6
 Circuit 2: 4A-R07, RG-6
 Circuit 3: 4A-R08, RG-6
 Circuit 4: 4A-R09, RG-6
 Quad Ground Block
 Heater: Circuit: 4A-A03, 16-2
 "White/E-Rack/3"

Attic: Camera
 On Roof Mast

Camera Video: 4A-S13 (RG-59)
 24 Vac Camera Power: 4A-A04 (18-2 Shielded)
 Camera Control: 4A-A05 (22-8 Shielded)

Do Not Use Siamese Cable
 "White/E-Rack/2"

Attic: Ground Wire
 Connected to Masts, Ground Blocks
 & Lightning Arrestor
 Circuit: 4A-R10, #8 Solid Copper
 To: Utility Room Ground System
 "White/CN-Panel/5"

Attic: VHF Antenna
 On Roof Mast
 Circuit: 4A-R04, RG-11
 (Cable in AI Conduit)
 Ground Block & Lightning Arrestor
 "White/CN-Panel/5"

Attic: Sat Antenna
 Base of Roof Mast
 Circuit: 4A-R05, RG-6, Local Pre-amp
 Ground Block
 "White/CN-Panel/3"

Attic: MW/SW Antenna
 On Roof Mast
 Circuit: 4A-R03, RG-6 (Quad Shield)
 (Cable in EMT Conduit) Ground Block
 "White/CN-Panel/5"

Scale: 12' ⇔ 1"

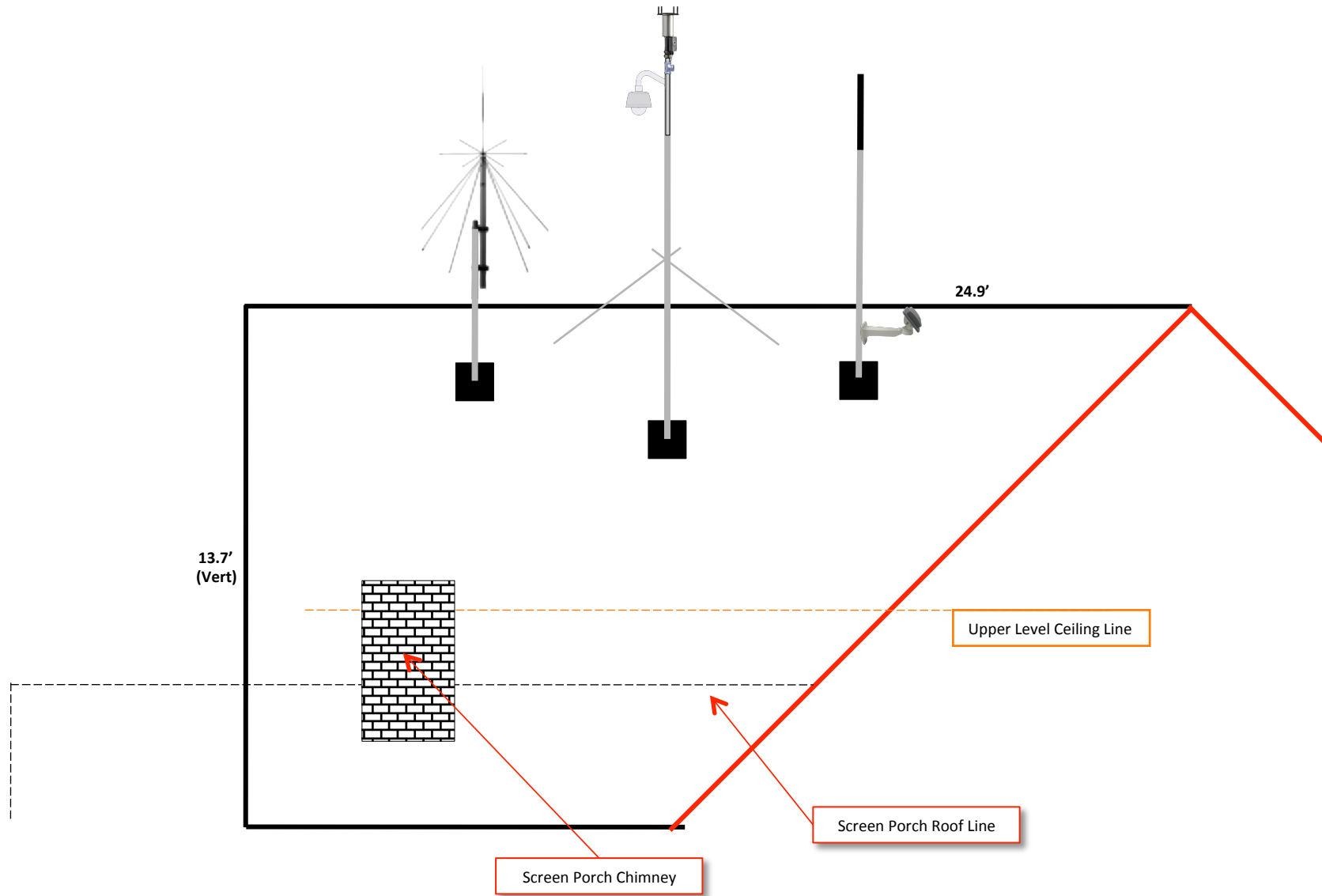

Scale: 4' ⇔ 1"

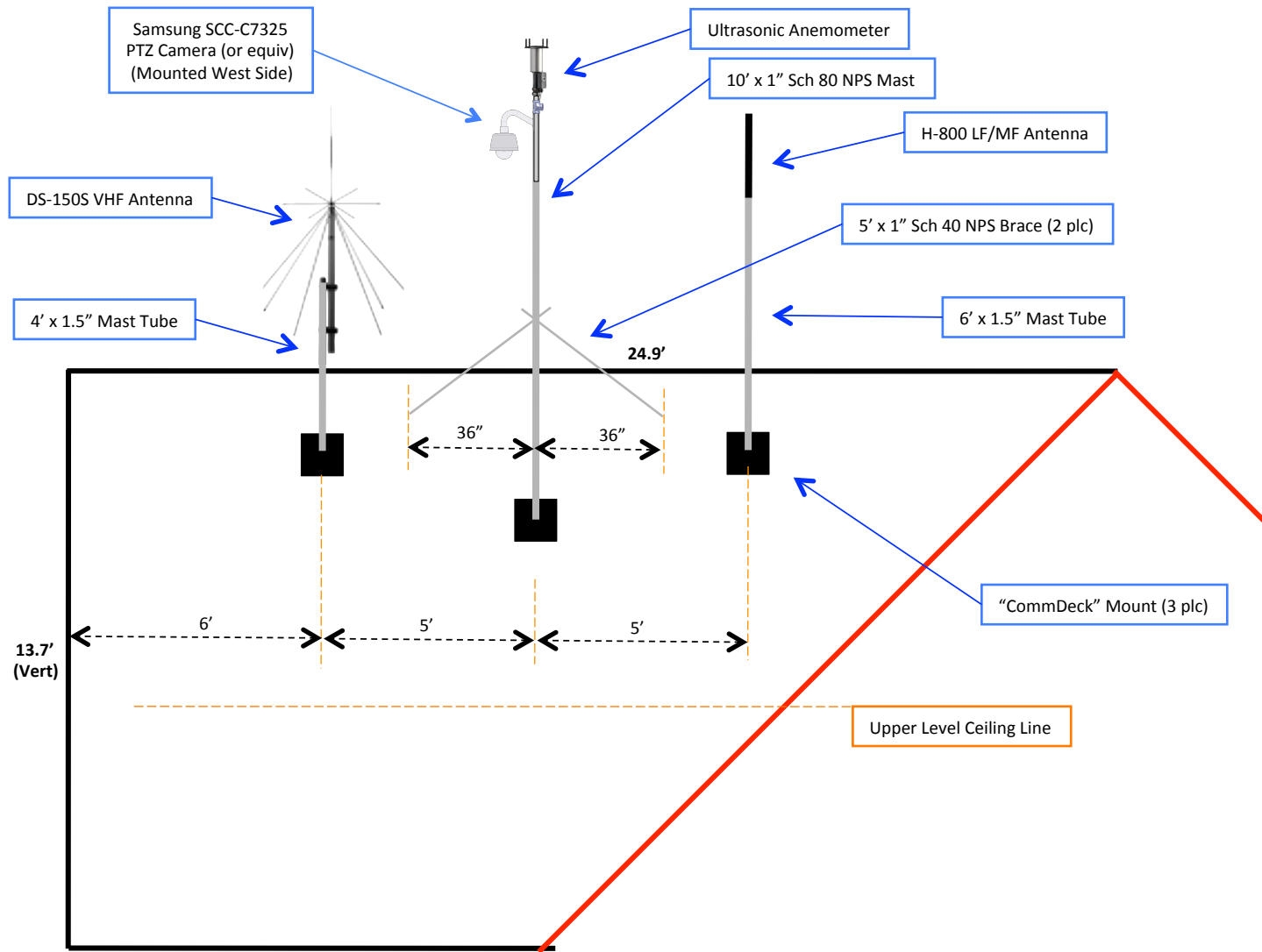

Scale: 4' ⇔ 1"

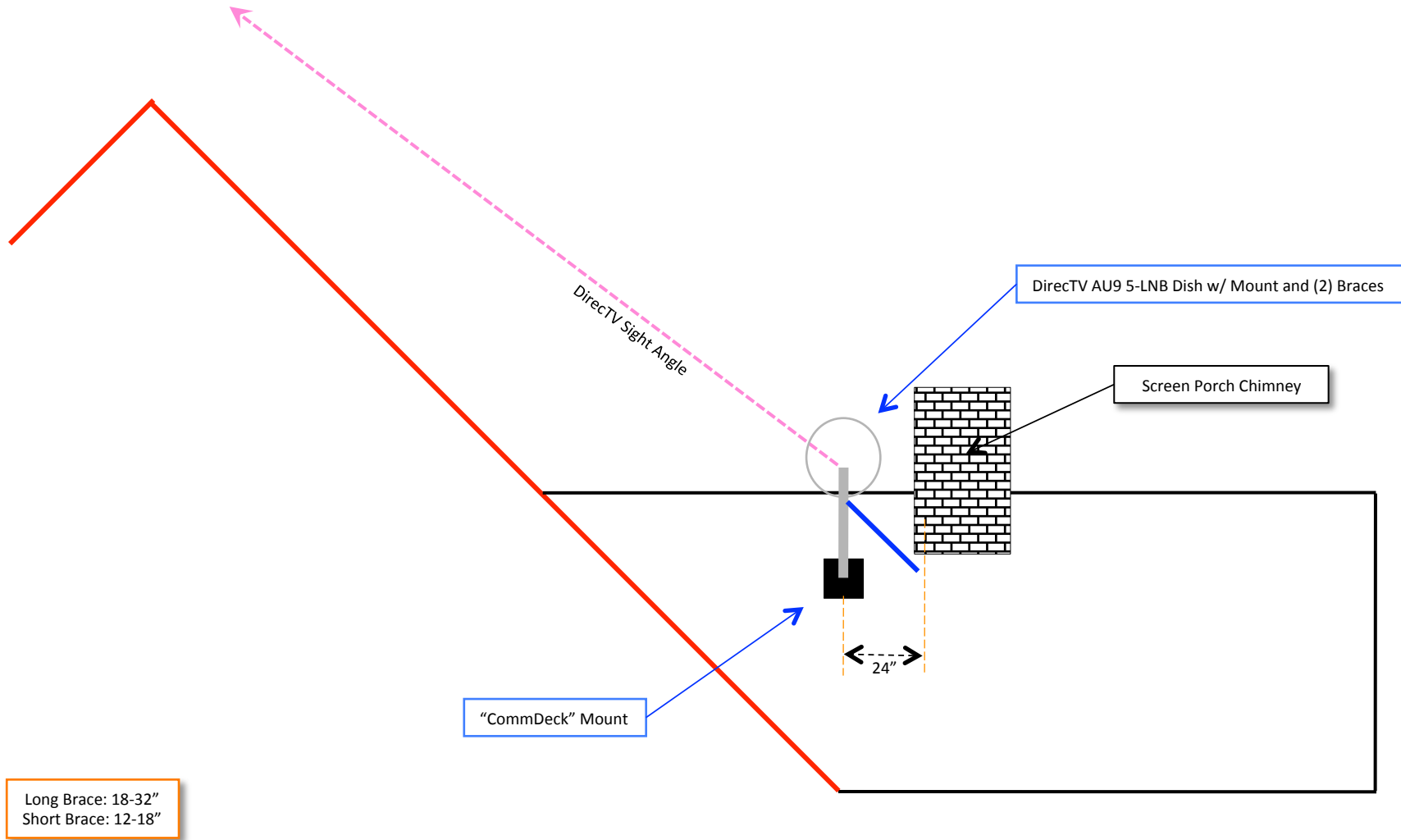

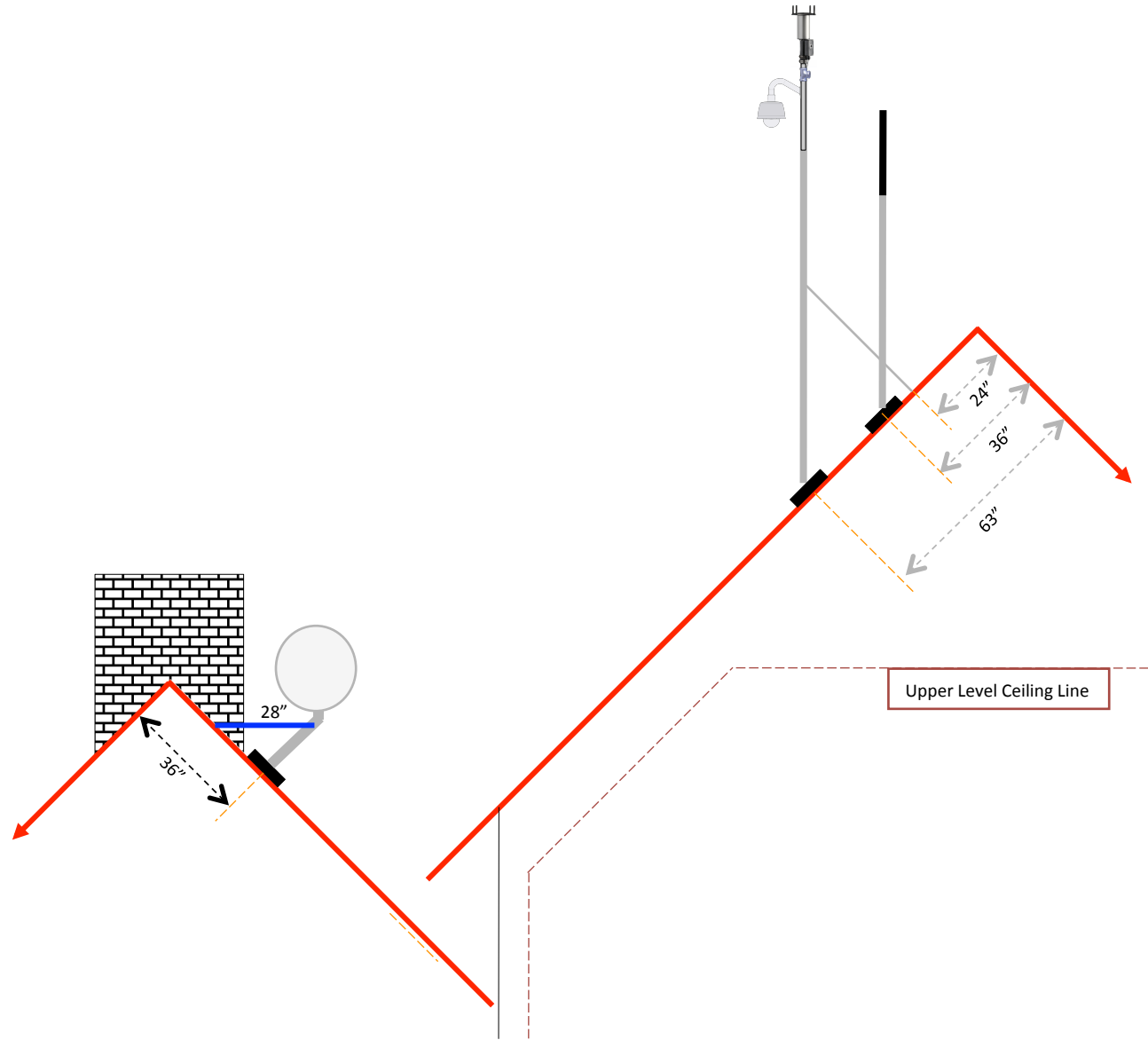

Scale: 4' ⇔ 1"

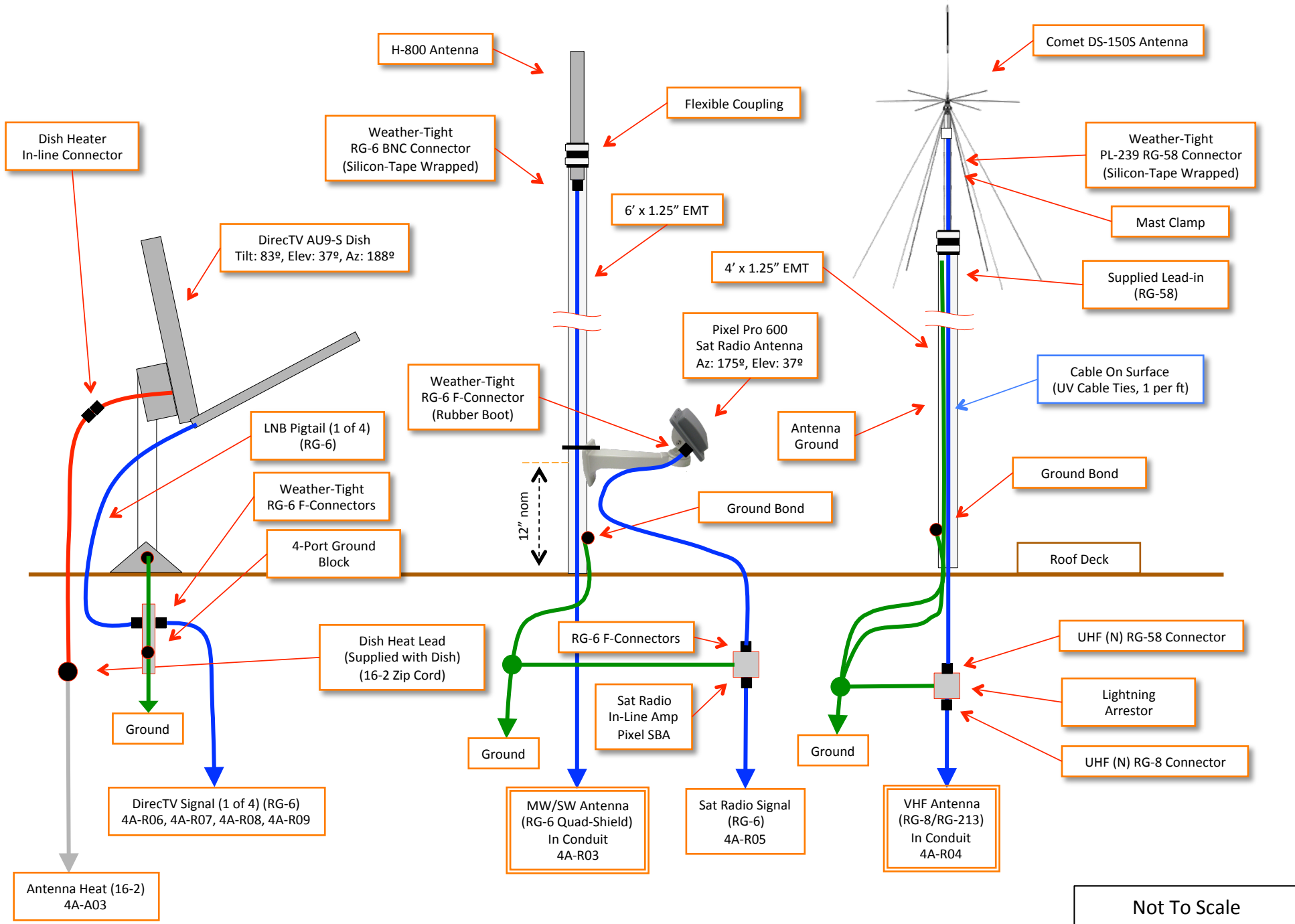

Not To Scale

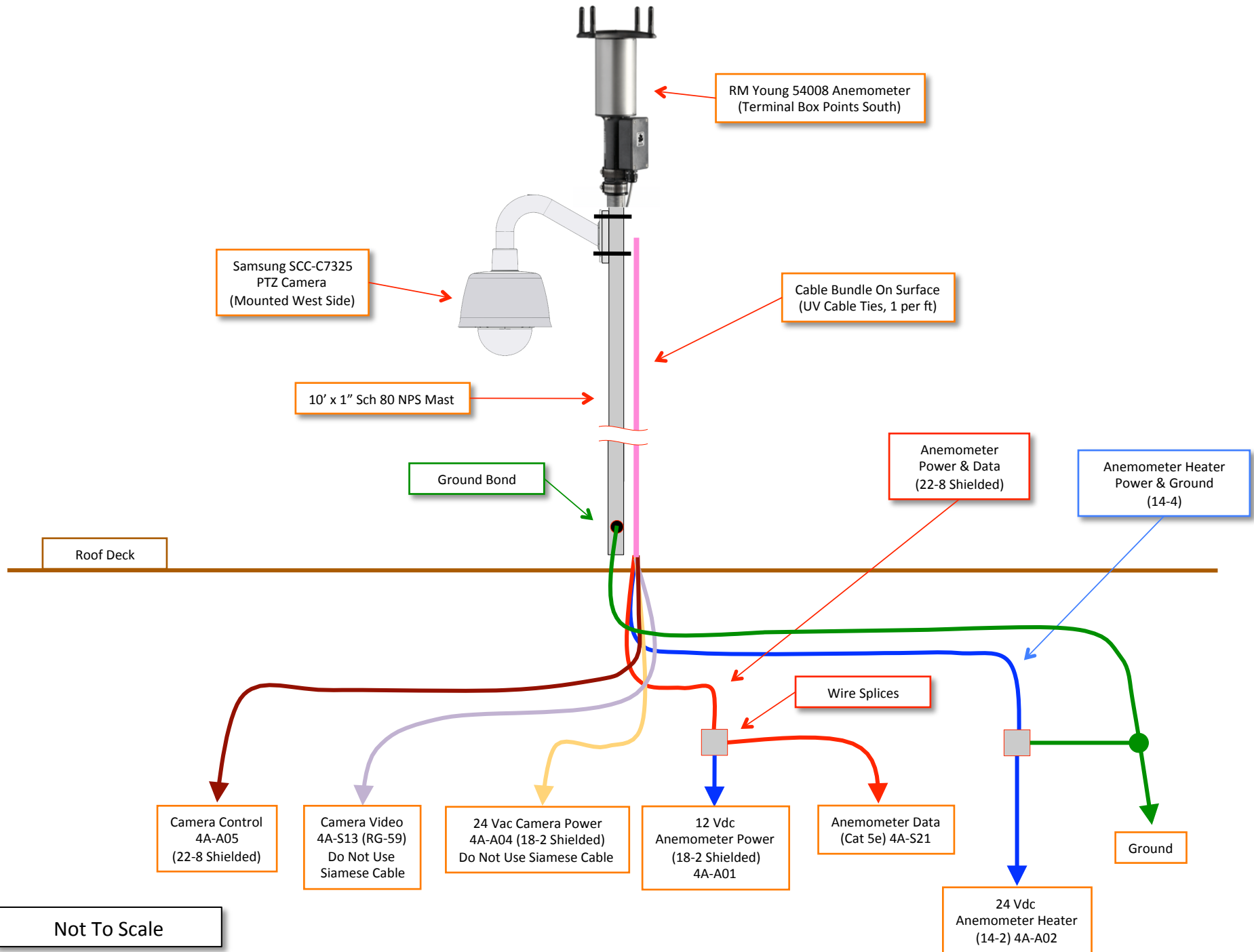

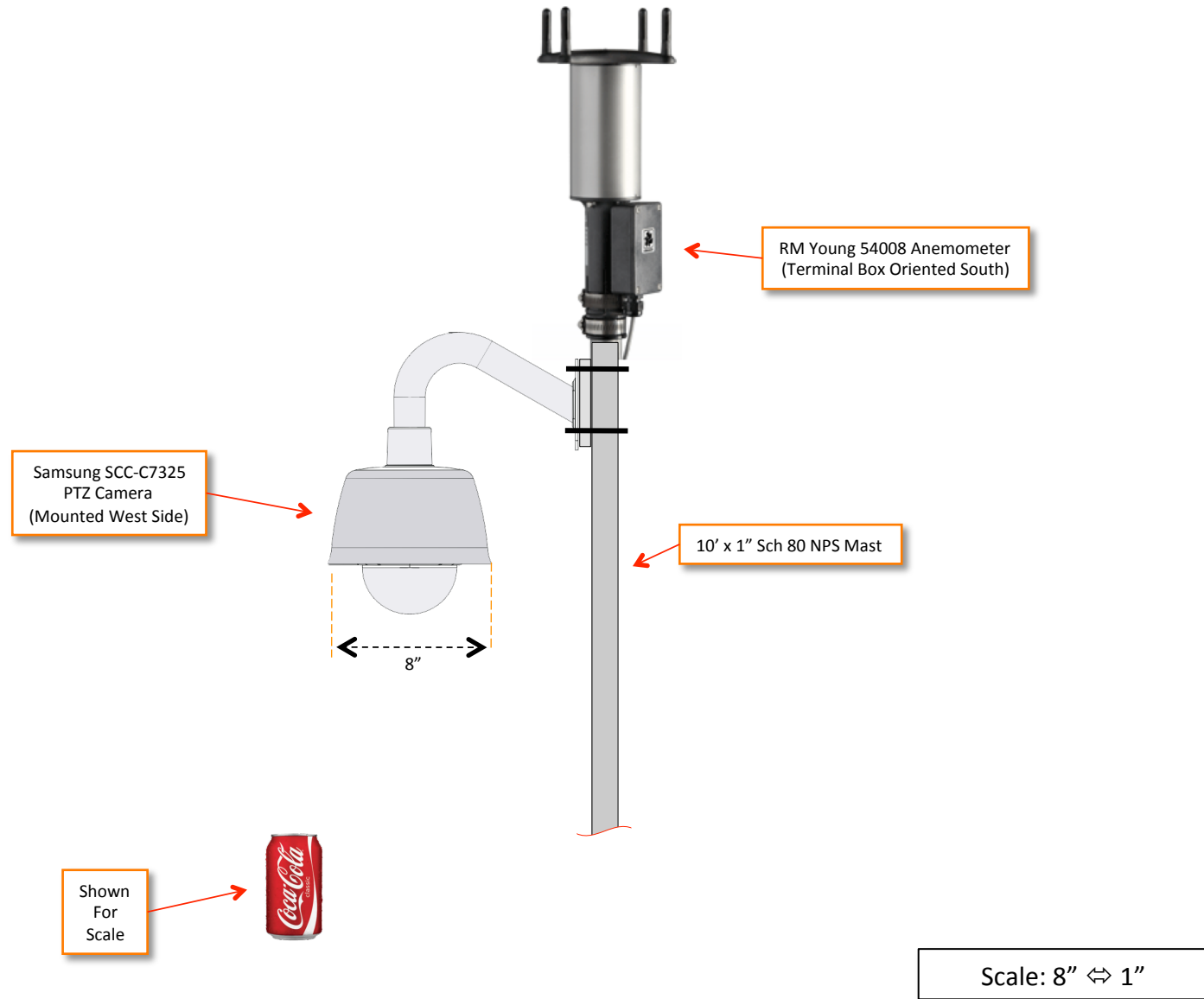

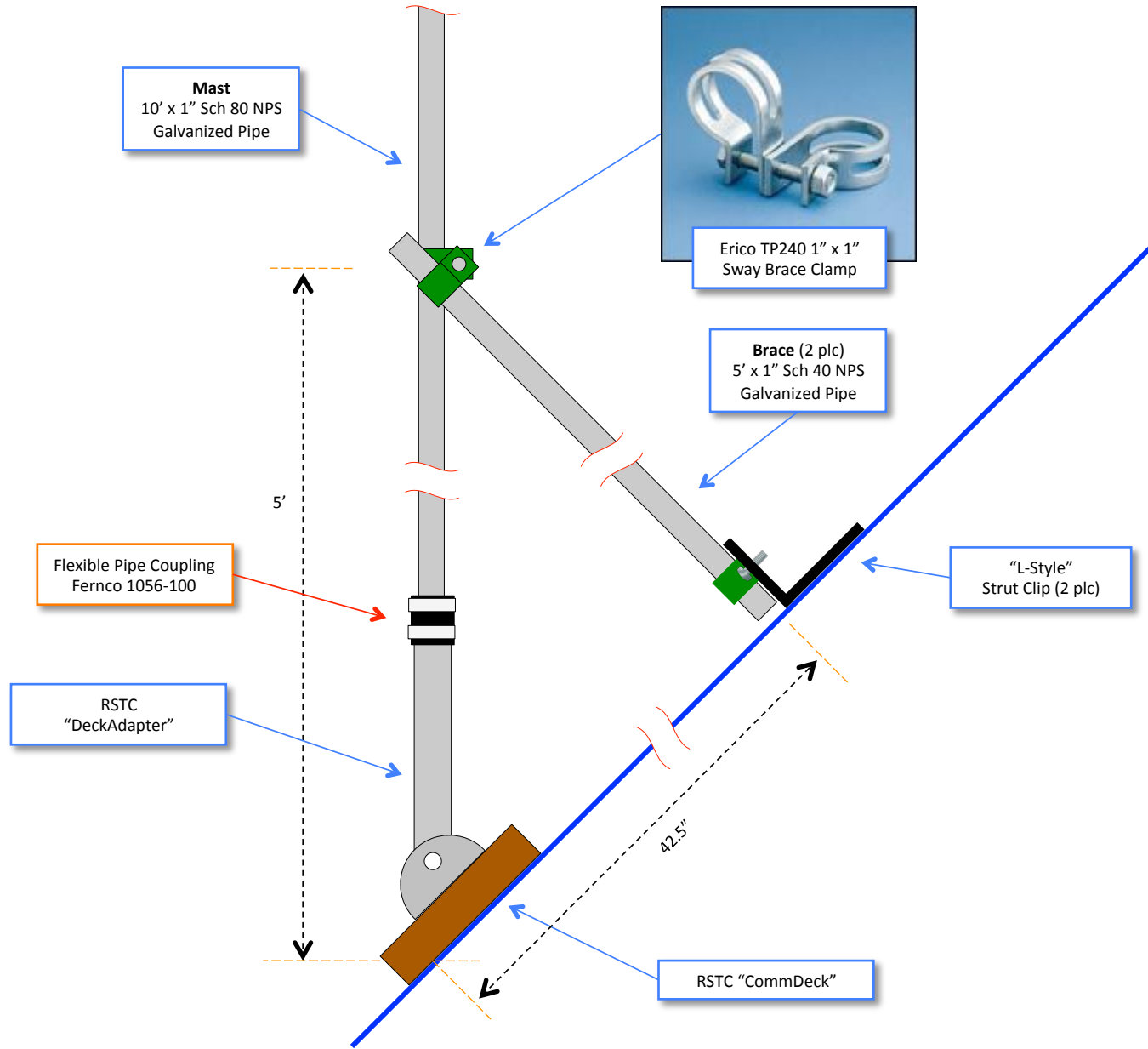

Scale: 8" ⇔ 1"

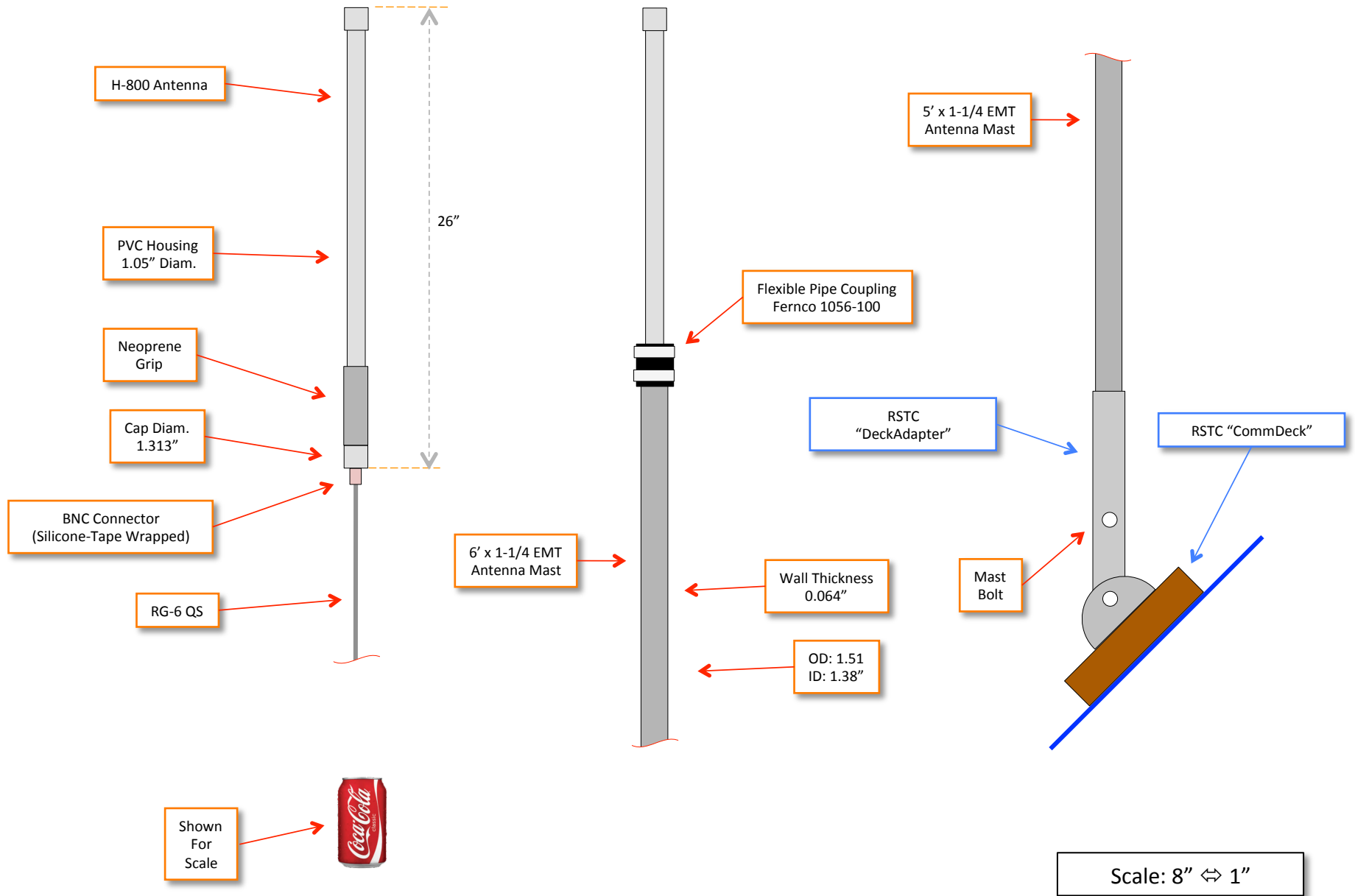

4A - Attic

VHF Antenna Mounting

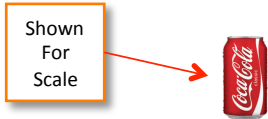
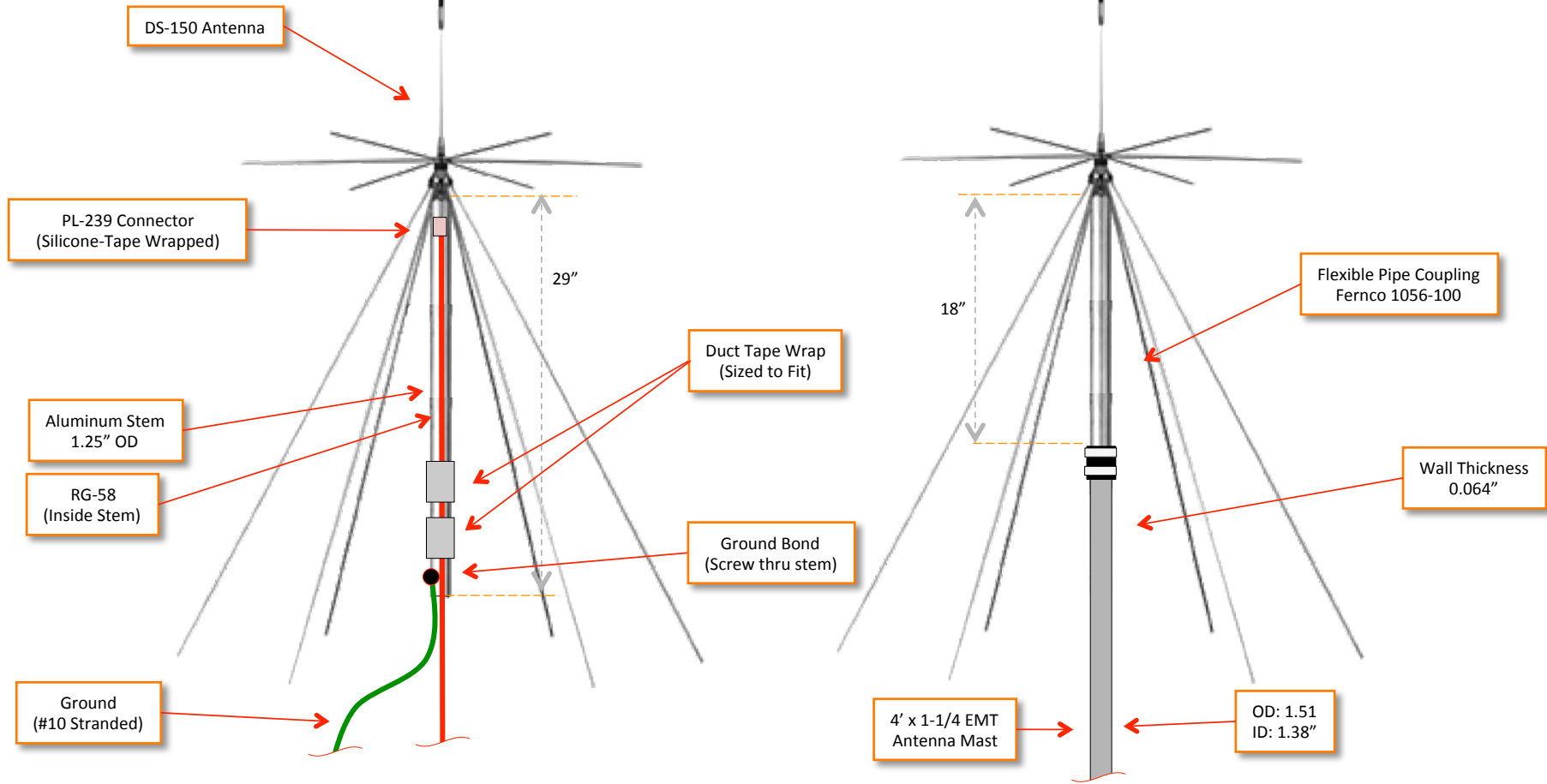

Scale: 12" ⇔ 1"

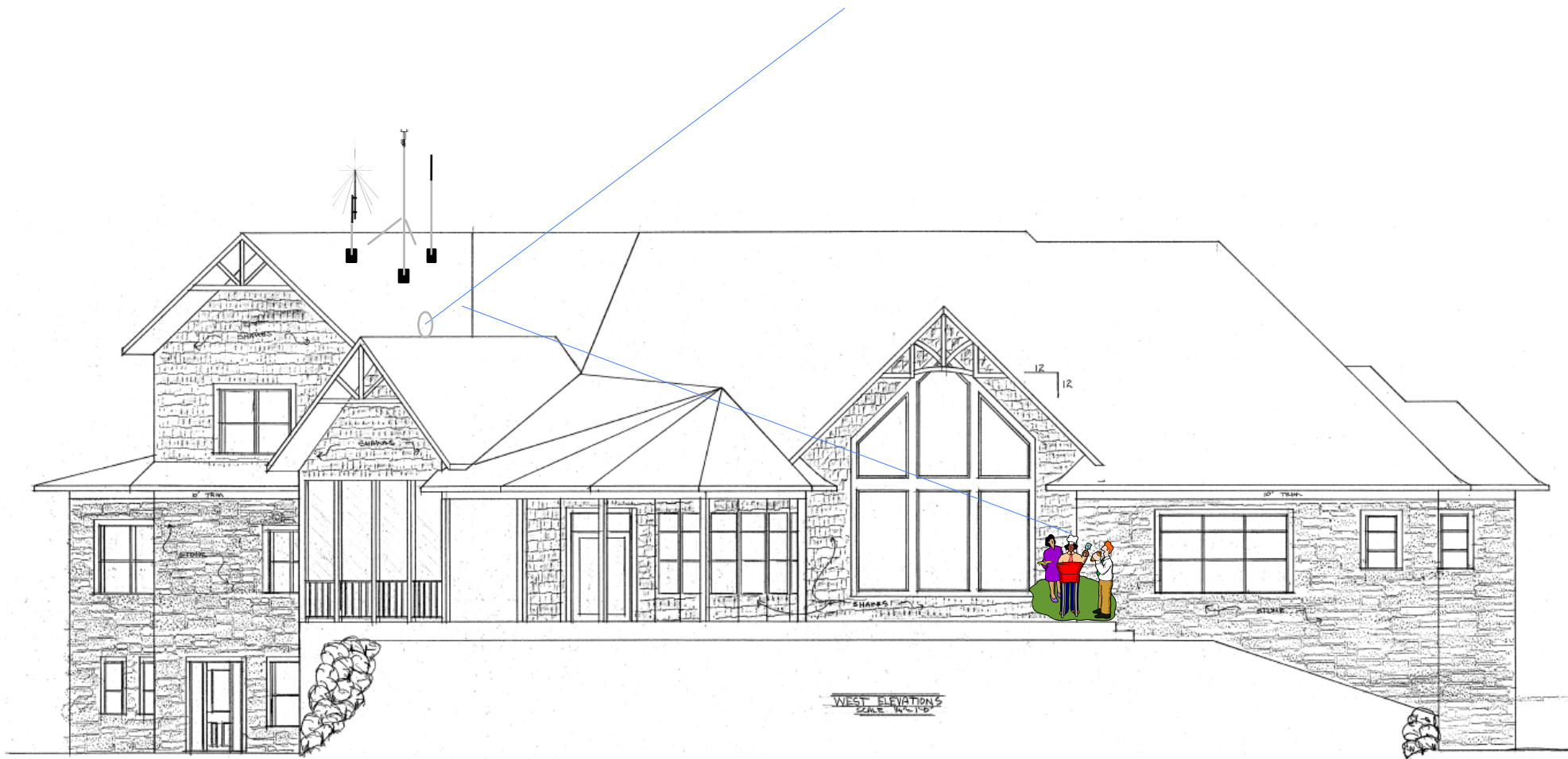

Scale: 12' ⇔ 1"

